



**Bath Road, Hounslow, TW3 3DB
Offers In Excess Of £1,925,000**

ANOTHER SALE BY STAMFORDS! A unique opportunity to purchase this substantial character property comprising two adjoining buildings of 491 sq m / 5286 sq ft, plus a large garden area of 571 sq m / 6065 sq ft as well as off street parking for seven/eight cars 294 sq m / 2690 sq ft. The property is situated on the Bath Road within walking distance of Hounslow West tube station, local shops, restaurants, bus routes and easy access to Heathrow Airport. The property is currently being used as staff accommodation with shared facilities and also has great scope for other commercial uses similar to other neighbouring properties, eg. bed/breakfast, guest house (STPP).

A partner of
The Guild Of Professional Estate Agents
with a network of over 700 independent estate agents

Associated Office: 121 Park Lane, Mayfair, London W1K 7AG t 020 7318 7075

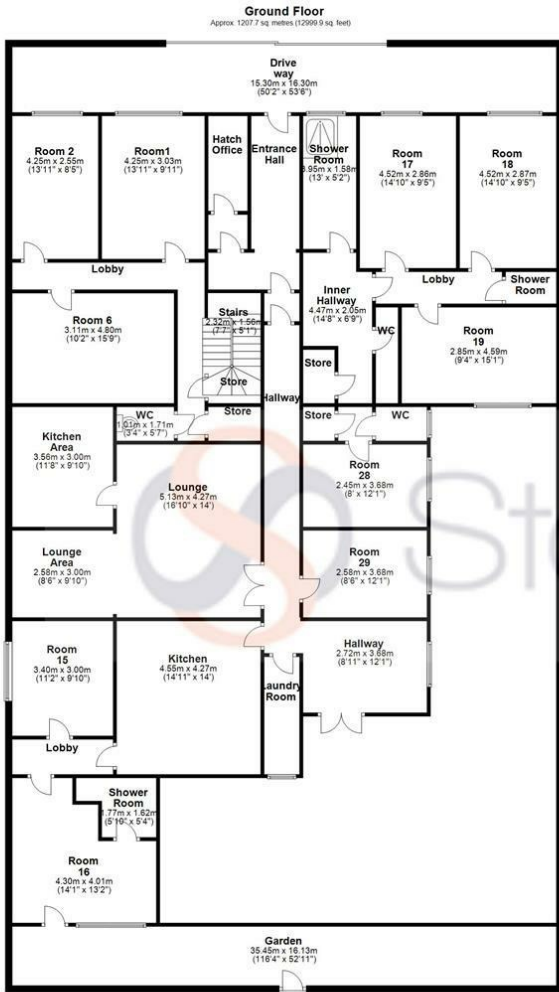

Main area: Approx. 1416.5 sq. metres (15247.1 sq. feet)
Plus roof terrace: approx. 22.8 sq. metres (245.5 sq. feet)

Whilst every attempt has been made to ensure the accuracy of the plan contained here, measurements of door windows, room and any other items are approximate and no responsibility is taken for any error, omission or mis-statement. This plan is for illustrative purposes only and should be used as such by any prospective purchaser. The service, systems and appliances shown here have not been tested and no guarantee as their operability or efficiency can be given. Plans produced using PlanUp.

293+295 bath road, Hounslow



A partner of
The Guild Of Professional Estate Agents
with a network of over 700 independent estate agents

Associated Office: 121 Park Lane, Mayfair, London W1K 7AG t 020 7318 7075